

**THREADFORM PROPERTIES**

<b>LEAD</b>	.28571 in (3.5 TPI)
	+ .006 OVER 2 INCHES
<b>TAPER</b>	1.250 in/ft (.1042 in/in)

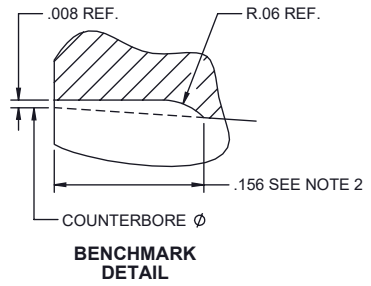

**DLC BOX FIELD INSPECTION DIMENSIONS**

CONNECTION	A BOX DEPTH		B MIN WALL	C COUNTERBORE		D BEVEL DIA.		E ROOT DAMAGE REGION DISTANCE	OD MIN SEE NOTE 5
	MIN	MAX		MIN	MAX	MIN	MAX		
DLC 425	4.561	4.570	.250	4.398	4.461	5.048	5.268	2.313	4.914
DLC 544	5.123	5.132	.313	5.590	5.653	6.381	6.601	2.563	6.232

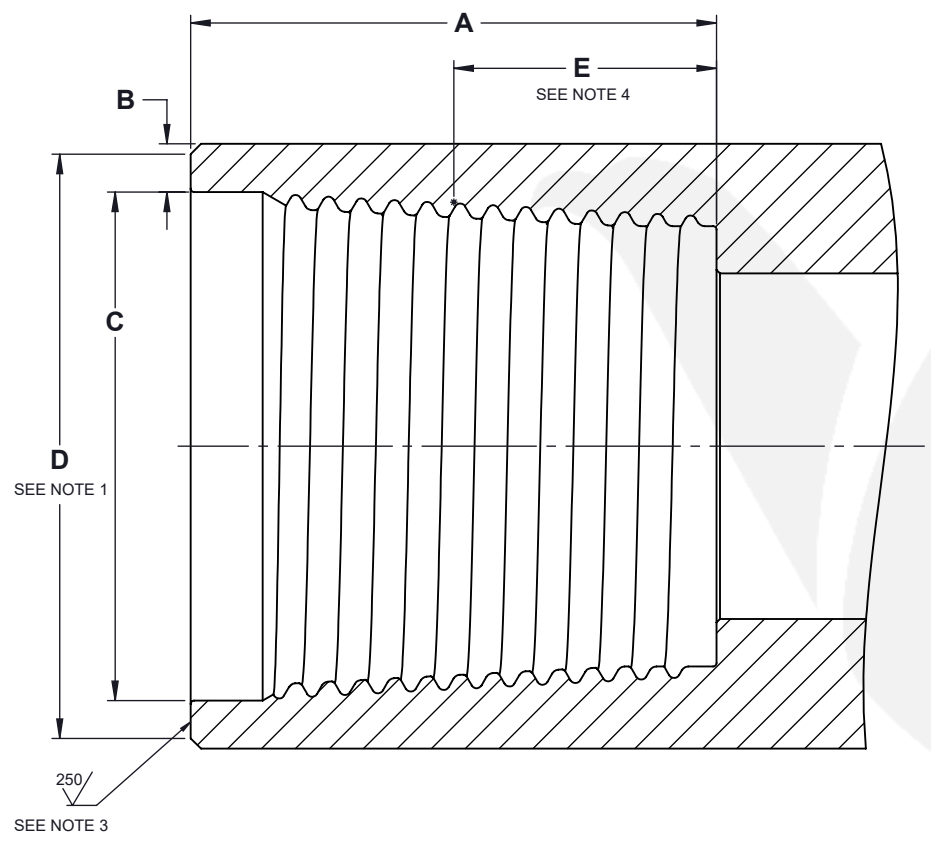

**NOTES:**

1. MIN BEVEL CHAMFER OF 1/32" X 45° TO BE PRESENT FOR REDUCED OD AND/OR REFACED CONNECTION
2. .156 IS FOR NEW CONDITION, MAY BE .062 MIN AFTER REFACING
3. SURFACE FINISH APPLIES DURING REFACING OPERATIONS
4. DAMAGE TO THREAD ROOTS NOT PERMITTED IN THIS REGION
5. MIN OD FOR REFERENCE BASED ON MIN BOX COUNTERBORE WALL THICKNESS

REV.	DESCRIPTION	DATE	REV. BY
1	CONVERTED TO LIMIT TOLERANCING	12/11/2025	SC
REVISIONS			

	TITLE <b>DLC BOX FIELD INSPECTION</b>				
					SCALE NONE
					SHEET 1 OF 1
DIMENSIONS IN INCHES UNLESS OTHERWISE SPECIFIED		DRAWN SC MAY 4/23	CHECKED GT MAY 8/23	DRAWING NO. <b>T000141</b>	REVISION <b>1</b>